

Property Information		
Parcel Number 30-004-025-000-0000	Owner Name & Address MOORE, RONALD P 21 RACE ST HIGHSPIRE, PA, 17034-1118	Mailing Name & Address MOORE, RONALD P 21 RACE ST HIGHSPIRE, PA, 17034-1118
Tax Year 2025 <input type="button" value="▼"/>		
Property Class R03 - 2 STORY RESIDENCE	Neighborhood 30001 - WEST OF LUMBER	Site Address 21 RACE ST
Township HIGHSPIRE BORO	Tax Code 30 - HIGHSPIRE BORO	Tax Status Taxable

Sales History						
Year	Document #	Sale Type	Sale Date	Sold By	Sold To	Price
2004	0532700327	7 Family/Gift	1/6/2004	RONALD P & MOORE TONI D MOORE	RONALD MOORE	\$1.00
1899	0028800428	12 Zero Value	12/30/1899	RONALD P & MOORE TONI D MOORE	RONALD P & MOORE TONI D MOORE	\$0.00

Related Names			
	Name	Relationship	Status
>	MOORE, RONALD P	PARCEL OWNER	CURRENT
>	MOORE, TONI D	PARCEL CO-OWNER	CURRENT

Assessments						
Annual School						
	Land	Building	Total	Pref. Land	Pref. Building	Pref. Total
Non-Exempt	14,300	48,000	62,300	0	0	0
Exempt	0	0	0	0	0	0
Total	14,300	48,000	62,300	0	0	0
Annual Billing						
	Land	Building	Total	Pref. Land	Pref. Building	Pref. Total
Non-Exempt	14,300	48,000	62,300	0	0	0
Exempt	0	0	0	0	0	0
Total	14,300	48,000	62,300	0	0	0
Note: Preferential assessment values are used for taxation when preferential values are greater than zero.						



RG2

RG2

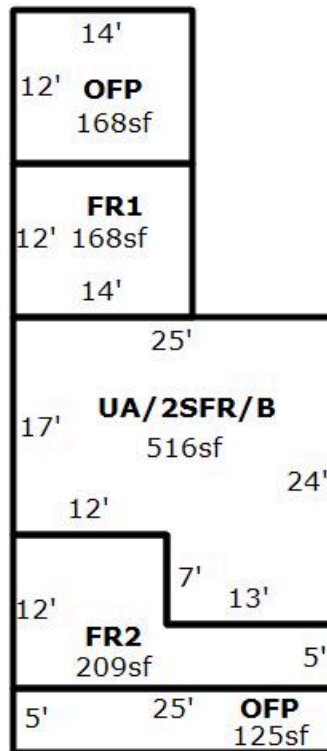

Payments							
Type	Billing Pd.	Tax Billed	Discount/Pen.	Total Billed	Total Paid	Total Due	Date Paid
RE	Annual Billing	\$2,114.33	(\$42.29)	\$2,072.04	\$2,072.04	\$0.00	2/28/2025
ST	Annual Billing	\$1,419.49	\$0.00	\$1,419.49	\$0.00	\$1,419.49	

Note: Payment amounts may only reflect the Dauphin County amounts

Tax Amounts - Annual Billing			
Fund (Tax) Description	Rate Type	Millage/Tax Rate	Flat Tax Amount
County Library	Millage	0.350000	\$21.81
County Real Estate	Millage	8.376000	\$521.82
HIGHSPIRE BORO - Trash	Rate	387.000000	\$387.00
MUN: HIGHSPIRE BORO	Millage	19.000000	\$1,183.70
Steelton-Highspire School District	Millage	30.425800	\$1,419.49
Total			\$3,533.82

No Abatements

No Delinquent Taxes

Exemption/Exclusions/Clean and Green						
Type	Status	Land Amount	Building Amount	Exemption Amount	Farmstead	Farmstead Value
Homestead	Appl Approved (Full)	14,300	48,000	62,300	No	0

Assessed Land Valuation						
Property Class	Description	Type	Sq. Ft.	Calc. Acres	Deed Acres	Value
RES - Residential	Primary Site	S1 - Primary Site	6,670	0.1500	0.11	14,300

Structre 1 of 1

Property Type	Description	Quality	Total Base Area	Gross Living Area	Year Built	Eff. Age	Value
RES - Residential	Two Story	C	516	1,747	1900	0	45,800

Attic, Unfinished

Frame Construction	516 Square Ft.
--------------------	----------------

Features

ROW HOUSE END	1
---------------	---

First Floor

Frame Construction	893 Square Ft.
--------------------	----------------

Second Floor

Frame Construction	725 Square Ft.
--------------------	----------------

Occupancy

Dwelling	1
----------	---

Exterior Walls

Frame or Equal	1
----------------	---

Addition - 1st Story

Frame Construction Addition	168 Square Ft.
-----------------------------	----------------

Frame Construction Addition	209 Square Ft.
-----------------------------	----------------

Foundation Adjustments

Full Basement, Frame	516 Square Ft.
----------------------	----------------

Full Basement in Addition	168 Square Ft.
---------------------------	----------------

Porches

Open Frame Porch	168 Square Ft.
------------------	----------------

Open Frame Porch	125 Square Ft.
------------------	----------------

Plumbing Detail

Extra Fixtures	2
----------------	---

Half Bath	1
-----------	---

Full Bath	1
-----------	---

Accommodations

Number of Stories	2
Finished Living Area	1,747
Number of Full Bathrooms	1
Number of Half Bathrooms	1
Number of Bedrooms	3

Addition - 2nd Story

Frame Construction Addition	209 Square Ft.
-----------------------------	----------------

[Map/GIS](#)

[View Full Screen](#)

© 2025 [DEVNET, Inc](#)

Data updated: 2025-09-01 17:15:00

wEdge Version: 5.1.9363.29030

Assembly Date: 2025/08/20