

Property Information

Property ID	570-79293-0-0000	Property Use	100 - RESIDENTIAL
Tax Year	2023	Land Use	113 - SINGLE FAMILY DWELLING
Township	570 Strasburg Boro	Tax Status	Taxable
Site Address	1 PROSPECT RD	Clean & Green	No

Property Sketches & Photos

1-1

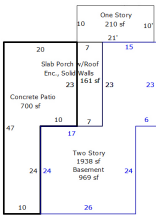

Source: Esri, DeLorme

Imported Image



Parcel photo



Imported Image



Related Names

Parcel Owner	BAXTER TRUMAN J, 1 PROSPECT RD STRASBURG, PA 17579	Parcel Owner	BAXTER CAROLINE E, 1 PROSPECT RD STRASBURG, PA 17579
Status	Current	Status	Current

Assessments						
Annual Billing						
	Land	Building	Total	Pref. Land	Pref. Building	Pref. Total
Non-Exempt	182,900	82,100	265,000	0	0	0
Exempt	0	0	0	0	0	0
Total	182,900	82,100	265,000	0	0	0
Note: Preferential assessment values are used for taxation when preferential values are greater than zero.						

Property Characteristics			
Electric	Gas	Sewage	Water
HOOKED-UP	NONE	PUBLIC SYSTEM	PUBLIC SYSTEM

Market Land Valuation			
Property Type	Land Type	Sq. Ft.	Calc. Acres
RES - Residential	2 - PRIMARY HOMESITE	8,712	0.2000
RES - Residential	6 - RESIDUAL	121,968	2.8000

Structure 1 of 7

Property Type	Description	Style	Total Living Area	Year Built																																				
RES - Residential	FARM-HOUSE #1	Two Story	2,148	1875																																				
<div><div><div>Accommodations</div><table><tr><td>Extra Fixtures</td><td>2</td></tr><tr><td>Full Baths</td><td>2</td></tr><tr><td>Number of Bedrooms</td><td>4</td></tr><tr><td>Number of Families</td><td>1</td></tr><tr><td>Number of Rooms</td><td>8</td></tr></table></div><div><div>Fuel Type</div><table><tr><td>Fuel Type</td><td>Oil</td></tr></table></div><div><div>Miscellaneous Non-Residence</div><table><tr><td>02AT-FAIR</td><td>1.00 Units</td></tr></table></div><div><div>Porches, Decks, Breezeways</div><table><tr><td>Enclosed Porch, Solid Walls</td><td>393.00 Sq.Ft.</td></tr><tr><td>Slab Porch with Roof</td><td>161.00 Sq.Ft.</td></tr></table></div><div><div>Story Height</div><table><tr><td>Number of Stories</td><td>2.00</td></tr></table></div></div> <div><div><div>Basement</div><table><tr><td>Total Basement Area</td><td>969.00 Sq.Ft.</td></tr></table></div><div><div>Exterior Walls</div><table><tr><td>Frame, Plywood</td><td>2148.00 Sq.Ft.</td></tr></table></div><div><div>Fireplaces</div><table><tr><td>Single 2-Story Fireplace</td><td>1.00 Units</td></tr></table></div><div><div>Heating/Cooling</div><table><tr><td>Add for Oil Fired</td><td>2148.00 Sq.Ft.</td></tr><tr><td>Forced Air Furnace</td><td>2148.00 Sq.Ft.</td></tr></table></div><div><div>Paving/Decking</div><table><tr><td>Concrete, Unreinforced Hand Mixed and Spread</td><td>700.00 Sq.Ft.</td></tr></table></div><div><div>Roofing</div><table><tr><td>Slate</td><td>2148.00 Sq.Ft.</td></tr></table></div><div><div>Style</div><table><tr><td>Style</td><td>FARM-HOUSE</td></tr></table></div></div>					Extra Fixtures	2	Full Baths	2	Number of Bedrooms	4	Number of Families	1	Number of Rooms	8	Fuel Type	Oil	02AT-FAIR	1.00 Units	Enclosed Porch, Solid Walls	393.00 Sq.Ft.	Slab Porch with Roof	161.00 Sq.Ft.	Number of Stories	2.00	Total Basement Area	969.00 Sq.Ft.	Frame, Plywood	2148.00 Sq.Ft.	Single 2-Story Fireplace	1.00 Units	Add for Oil Fired	2148.00 Sq.Ft.	Forced Air Furnace	2148.00 Sq.Ft.	Concrete, Unreinforced Hand Mixed and Spread	700.00 Sq.Ft.	Slate	2148.00 Sq.Ft.	Style	FARM-HOUSE
Extra Fixtures	2																																							
Full Baths	2																																							
Number of Bedrooms	4																																							
Number of Families	1																																							
Number of Rooms	8																																							
Fuel Type	Oil																																							
02AT-FAIR	1.00 Units																																							
Enclosed Porch, Solid Walls	393.00 Sq.Ft.																																							
Slab Porch with Roof	161.00 Sq.Ft.																																							
Number of Stories	2.00																																							
Total Basement Area	969.00 Sq.Ft.																																							
Frame, Plywood	2148.00 Sq.Ft.																																							
Single 2-Story Fireplace	1.00 Units																																							
Add for Oil Fired	2148.00 Sq.Ft.																																							
Forced Air Furnace	2148.00 Sq.Ft.																																							
Concrete, Unreinforced Hand Mixed and Spread	700.00 Sq.Ft.																																							
Slate	2148.00 Sq.Ft.																																							
Style	FARM-HOUSE																																							

Structure 2 of 7

Property Type	Description	Style	Total Living Area	Year Built
RES - Residential	Detached Structure #1	Outbuildings	480	1932

Garages

017 - Concrete Block Garage	480.00 Square Ft.
-----------------------------	-------------------

Structure 3 of 7

Property Type	Description	Style	Total Living Area	Year Built
RES - Residential	Detached Structure #2	Outbuildings	2,688	1900

Barns

001-04 - Bank Barn - Wood Frame	2688.00 Square Ft.
---------------------------------	--------------------

Structure 4 of 7

Property Type	Description	Style	Total Living Area	Year Built
RES - Residential	Detached Structure #3	Outbuildings	864	1900

Sheds

042-04 - Implement Shed - Wood Frame	864.00 Square Ft.
--------------------------------------	-------------------

Structure 5 of 7

Property Type	Description	Style	Total Living Area	Year Built
RES - Residential	Detached Structure #4	Outbuildings	270	1900

Sheds

069-04 - Storage Shed - Wood Frame	270.00 Square Ft.
------------------------------------	-------------------

Structure 6 of 7

Property Type	Description	Style	Total Living Area	Year Built
RES - Residential	Detached Structure #5	Outbuildings	168	1900

Sheds

063-04 - Enclosed Shed - Wood Frame	168.00 Square Ft.
-------------------------------------	-------------------

Structure 7 of 7				
Property Type	Description	Style	Total Living Area	Year Built
RES - Residential	Detached Structure #6	Outbuildings	600	1900
<div><div>Lean-Tos</div><div><div>044 - Lean To</div><div>600.00 Square Ft.</div></div></div>				

Exemptions		
Exemption Type	Status	Farmstead
Homestead	Appl Approved (Full)	No

Sales History						
Year	Document #	Sale Type	Sale Date	Sold By	Sold To	Price
2008	05687703		3/3/2008	BAXTER CAROLINE E	BAXTER CAROLINE E	\$1